

*Ultimate throughput and pursuit
of dispensing quality.*

NEW



Underfill dispensing



**Rise up two-times better than
convention model**

- Dispensing through the use of AeroJet technology
- Equipped with automatic express alignment

Increase in device yield

- Automatic dispensing volume management system

Progress of operating

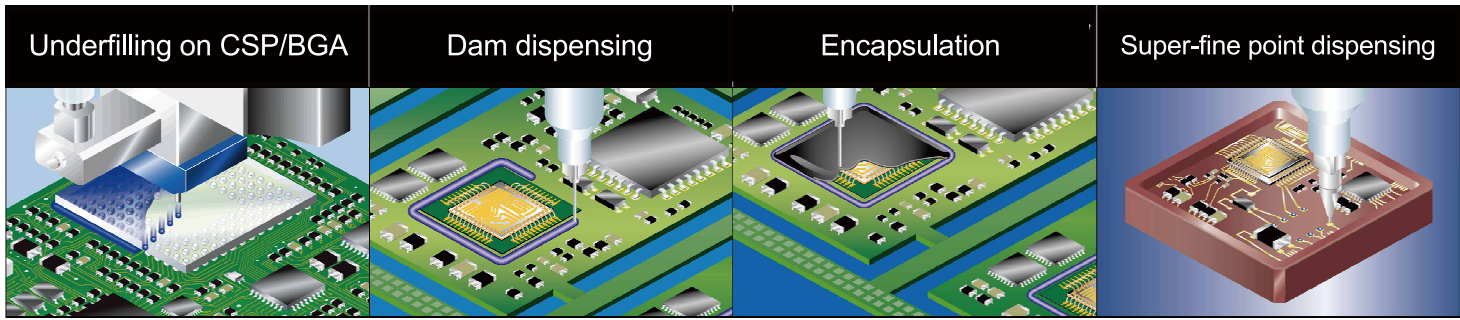

FEATURES

Improved productivity

- Rise up two-times better than convention model.

Increase in device yield

- Automatic dispensing volume management system.

Improve user-friendness

- Improved machine operability with new navigation system.

EXTERNAL DIMENSION DRAWINGS

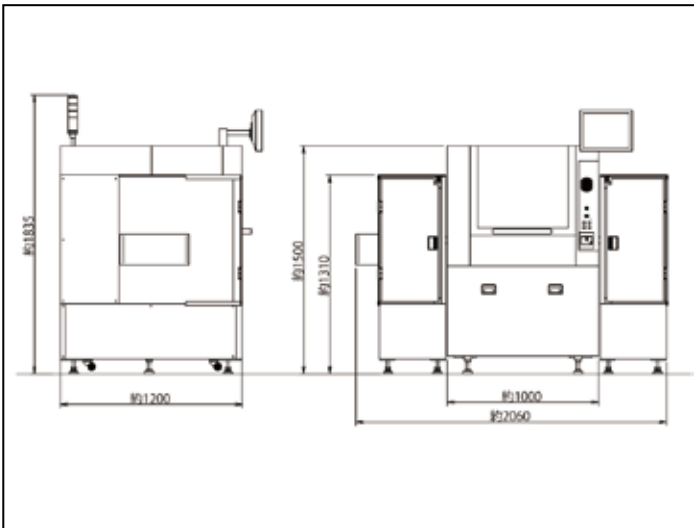

SPECIFICATIONS

Uses	Underfilling , damming and encapsulation , finepoint dispensing	
Applications scope	(W)315×(D)150mm	
Max , feeding speed	X and Y-axis : 2000mm/ s Z-axis : 500mm/ s	
Dispensing system	Mechanical type (AeroJet for FA machine)	
Dispensing program	Dispensing pattern auto programing software installed	
Power supply	200V Three phase	
consumption current	30A Max	
External Dimentions	Main Body	(W)1000×(D)1200×(H)1500mm
	Loader	(W)700×(D)1200×(H)1350mm
	Unloader	(W)450×(D)1200×(H)1350mm
Weight	Main Body	1150kg
	Loader	135kg
	Unloader	130kg



MUSASHI ENGINEERING, INC. (headquarters) is certified and registered according to the ISO 9001 Quality Management System and the ISO 14001 Environmental Management System.



<http://www.musashi-engineering.co.jp/english/>

World Leading Dispenser
MUSASHI ENGINEERING, INC.

HEAD OFFICE
8-7-4, Shimorenjaku, Mitaka, Tokyo, 181-0013, Japan TEL : (81)422-76-7111 / FAX : (81)422-76-7122
BRANCH
TOKYO, OSAKA, NAGOYA, SENDAI, FUKUOKA, SAITAMA, NAGANO, EAST-KANTO, AKITA, KANAZAWA

- SINGAPORE** 10 Ubi Crescent #05-24 Ubi Techpark Lobby B Singapore 408564
TEL : (65)6258-2422 / FAX : (65)6258-4844
- THAILAND** No.12 Soi Bangna-Trad 25, Bangnanuea, Bangna Bangkok, 10260 Thailand
TEL : (66)2-022-9015 / FAX : (66)2-769-5450
- INDONESIA** Jl. MH. Thamrin, Robson Square, Block A-15, Lippo Cikarang, Bekasi 17550, Jawa Barat, Indonesia
TEL : (62)21-8990-5005/ FAX : (62)21-8990-5004
- GERMANY** Marcel-Breuer-Str. 15, D-80807 Munich, Germany
TEL : (49)89-321996-06 / FAX : (49)89-321996-07
- KOREA** (902 No. 9 F. #C, Korea Bio Park.) 700, Daewangpangyo-ro, Bundang-gu, Seongnam-si, Gyeonggi-do 13488, Korea
TEL : (82)31-702-3811 / FAX : (82)31-702-3881
- TAIWAN** 8F-2, No. 158, Sec. 2, Gongdao 5th Road, Hsinchu, Taiwan 30070
TEL : (886)3-572-9200 / FAX : (886)3-572-9300

- CHINA**
- HONG KONG** Unit 1706, 17/F., Greenfield Tower,(South)Concordia Plaza, No.1 Science Museum Road, T.S.T.East, Kowloon, H.K.
TEL : (852)2620-5799 / FAX : (852)2620-5771
- SHANGHAI** A-120 Room, No.525 Xian Feng Street (No.55 Jin Yu Road), Min Hang, Shanghai, China
TEL : (86)21-6446-7881 / FAX : (86)21-6446-7882
- SHENZHEN** Room 702, West Tian'an Tech Plaza II, Tian'an Cyber Park, Futian District Shenzhen, China
TEL : (86)755-8346-6822 / FAX : (86)755-8346-6866
- TIANJIN** Room 1206, Sino Ocean International Center, No. 40 Huachang Road, Hedong District, Tianjin
TEL : (86)22-5856-2051
- SUZHOU** Room 1010, No.188 Wang Dun Road, GENWAY BUILDING, Suzhou City Industrial estate Distric, Jiangsu, CHINA
TEL : (86)512-6878-4428 / FAX : (86)512-6878-4438